

HAND SANITIZING STAND ASSEMBLY

- First, use all 4 of your rubber inserts and place them with the point up through the bottom face of the base.
 - The larger side of the inserts should be contacting the ground when the stand is fully assembled.
- Next, take the pipe, without the insert placed in the end, and screw it clockwise into the base plate.
- Then, take the remaining pipe, with the insert for the button-head screw, and screw it in clockwise to the pipe that was previously placed in the base plate.
- The only parts remaining should be the mounting bracket and a screw that runs through the bottom surface of the bracket.
 - Peel off the cover of the VHB tape on the top pipe before installing the mounting bracket.
- Take the button-head screw with the threaded end facing down and put it through the prefabricated hole in the mounting bracket.
- Lastly, thread the button-head screw into the second pipe up from the base.
 - Make sure the mounting bracket is squared up with the front and back sides of the base.
 - The sloped side of the mounting bracket should be facing the fully rounded edge of the base plate.
- Use the provided 5/16" Allen wrench and torque the screw until it is tight, so the bracket is flush and attached well with the top pipe.

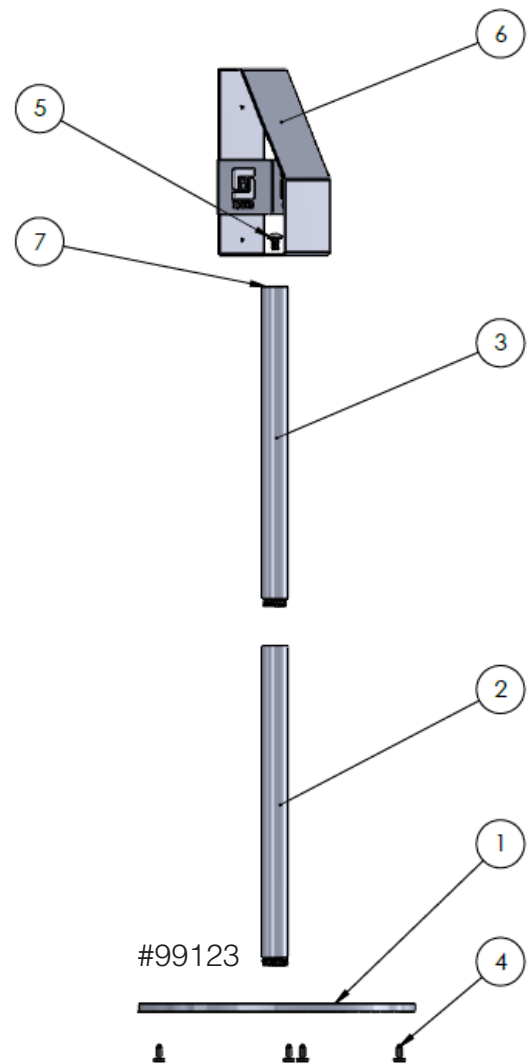

ITEM #	PART #	DESCRIPTION	QTY.
1	HS-STAND-7	BASE	1
2	HS-STAND-5	BOTTOM PIPE	1
3	HS-STAND-12	TOP PIPE ASSEMBLY	1
4	9310K14	PUSH-IN BUMPER	4
5	92949A710	1/2" - 13 X 3/4" BHCS, SS	1
6	HS-STAND-9	MOUNTING BRACKET ASSEMBLY	1
7	7170A14	VHB MOUNTING TAPE	1



Spartan Chemical Company, Inc.
www.spartanchemical.com

SERVICE/TECHNICAL SUPPORT
 1-800-537-8990